

# Round Green Through-hole LED Lamp (3mm)

## OVLBG4C7

- High Brightness with Well-defined Spatial Radiation Patterns
- UV-resistant Epoxy Lens
- Green (525nm)

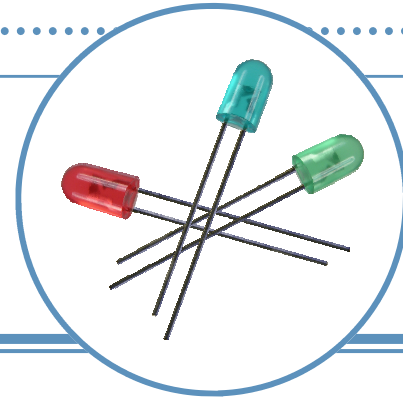

The OVLBG4C7 is a high-intensity InGaN LED mounted in a clear plastic T-1 package. Its UV-resistant epoxy lens makes this device an optimal solution for outdoor applications. This LED provides a well-defined and even emission pattern.

## Applications

- Pedestrian Signals
- Signage and Architectural Lighting
- Backlighting
- Automotive
- Outdoor/Indoor Displays

Part Number	Material	Emitted Color	Intensity Typ. mcd	Lens Color
OVLBG4C7	InGaN	Green	2000	Water Clear

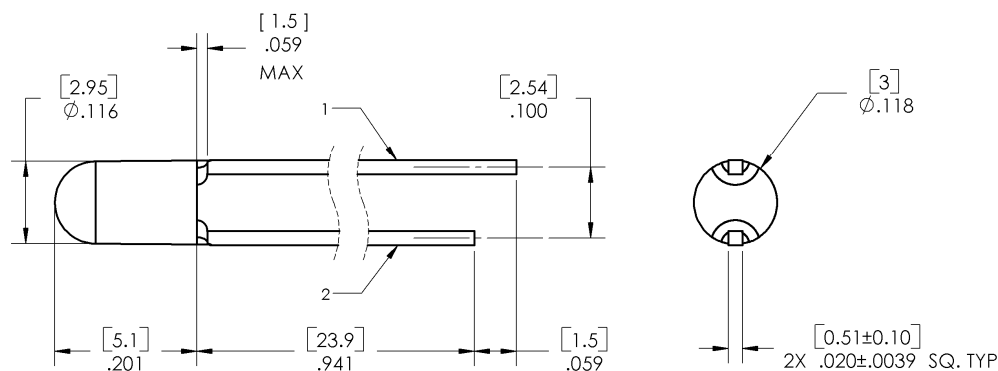

1 ANODE 2 CATHODE DIMENSIONS ARE IN INCHES AND [MILLIMETERS].

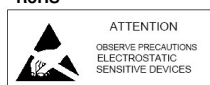

OPTEK reserves the right to make changes at any time in order to improve design and to supply the best product possible.

# Round Green Through-hole LED (3mm) OVLBG4C7



## Absolute Maximum Ratings

$T_A = 25^\circ\text{C}$  unless otherwise noted

Storage Temperature Range	-40 ~ +100°C
Operating Temperature Range	-40 ~ +85°C
Reverse Voltage	5 V
Continuous Forward Current	20 mA
Peak Forward Current (10% Duty Cycle, 1KHz)	50 mA
Power Dissipation	80 mW
Current Linearity vs. Ambient Temperature	-0.2 mA/°C
LED Junction Temperature	125°C
Lead Soldering Temperature (3mm from the base of the epoxy bulb) <sup>1</sup>	260°C

Note:

- Solder time less than 5 seconds at temperature extreme.

## Electrical Characteristics

$T_A = 25^\circ\text{C}$  unless otherwise noted

SYMBOL	PARAMETER	MIN	TYP	MAX	UNITS	CONDITIONS
$I_V$	Luminous Intensity	1285	2000	----	mcd	$I_F = 20\text{mA}$
$V_F$	Forward Voltage	----	3.4	4.0	V	$I_F = 20\text{mA}$
$I_R$	Reverse Current	----	----	50	$\mu\text{A}$	$V_R = 5\text{V}$
$\lambda_P$	Peak Wavelength	----	521	----	nm	$I_F = 20\text{mA}$
$\lambda_D$	Dominant Wavelength	519	525	531	nm	$I_F = 20\text{mA}$
$2\Theta_{1/2H-H}$	50% Power Angle	----	45	----	deg	$I_F = 20\text{mA}$

## Standard Bins ( $I_F = 20\text{mA}$ )

Lamps are sorted to luminous intensity ( $I_V$ ) and dominant wavelength ( $\lambda_D$ ) bins shown. Orders for OVLBG4C7 may be filled with any or all bins contained as below.

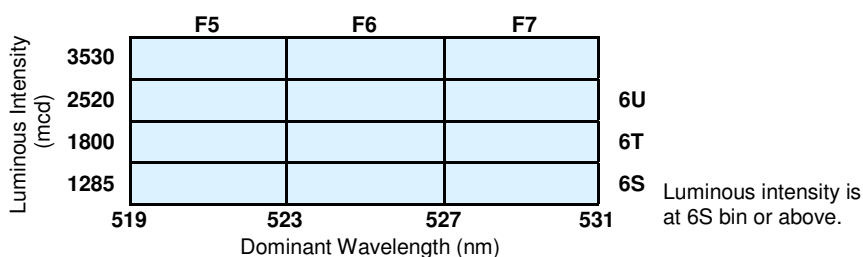

Forward Voltage

Rank	H	J	K	L
Voltage	2.6–3.0	3.0–3.3	3.3–3.6	3.6–4.0

### Important Notes:

- All ranks will be included per delivery, rank ratio will be based on the chip distribution.
- To designate luminous intensity ranks, please contact OPTEK.
- Pb content <1000PPM.

## Beam Pattern

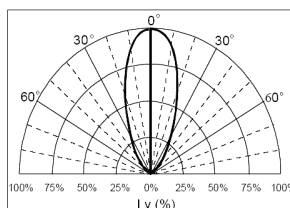

## Typical Electro-Optical Characteristics Curves

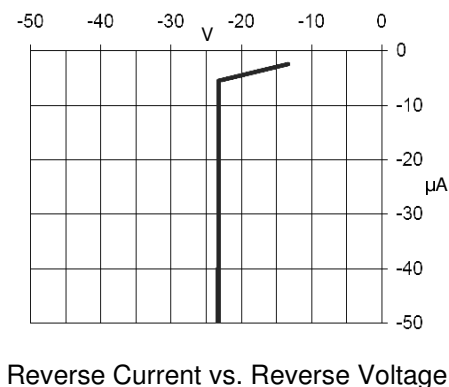
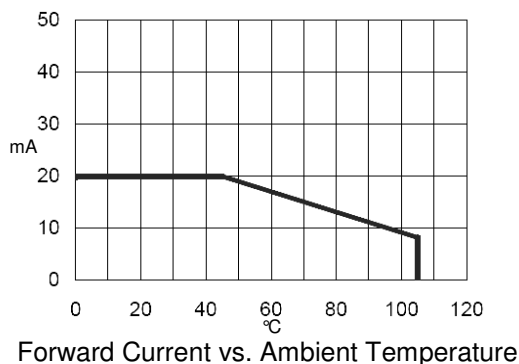
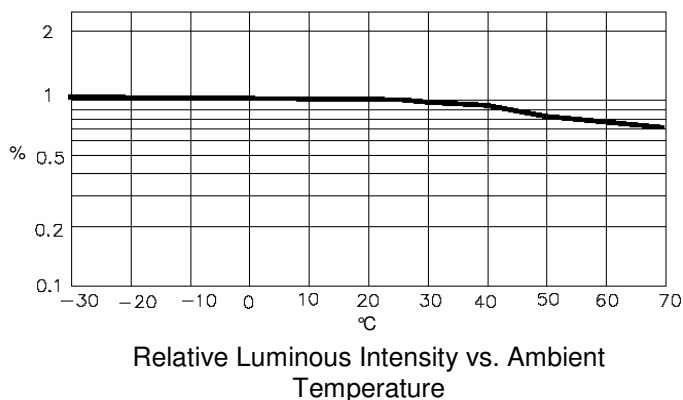
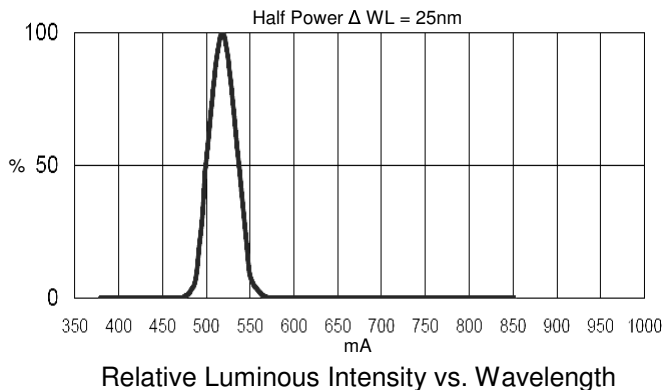
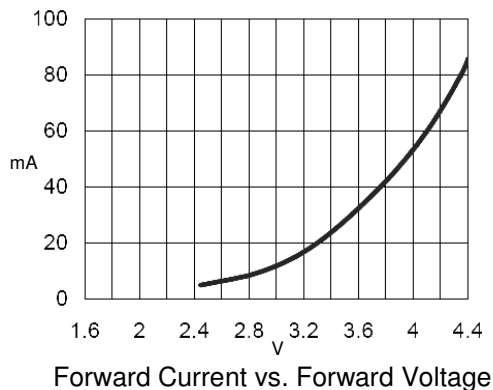

# Round Green Through-hole LED (3mm) OVLBG4C7

Packing Information: Available in Bulk or Reel

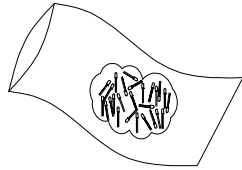

Bulk: 500 pcs/bag

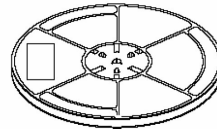

13-Inch Reel: 2500 pcs/reel

Carrier Tape Dimensions: Loaded Quantity 2500 PCS per Reel

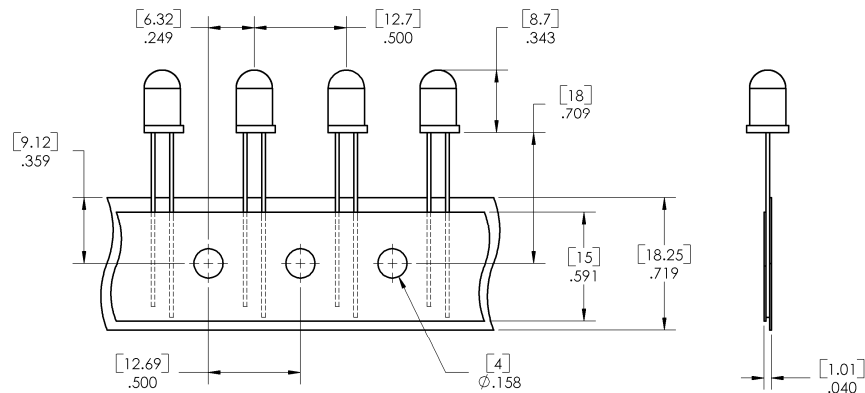

DIMENSIONS ARE IN INCHES AND [MILLIMETERS].

Moisture Resistant Packaging

